

STG-900-KIT-B | Reference Guide

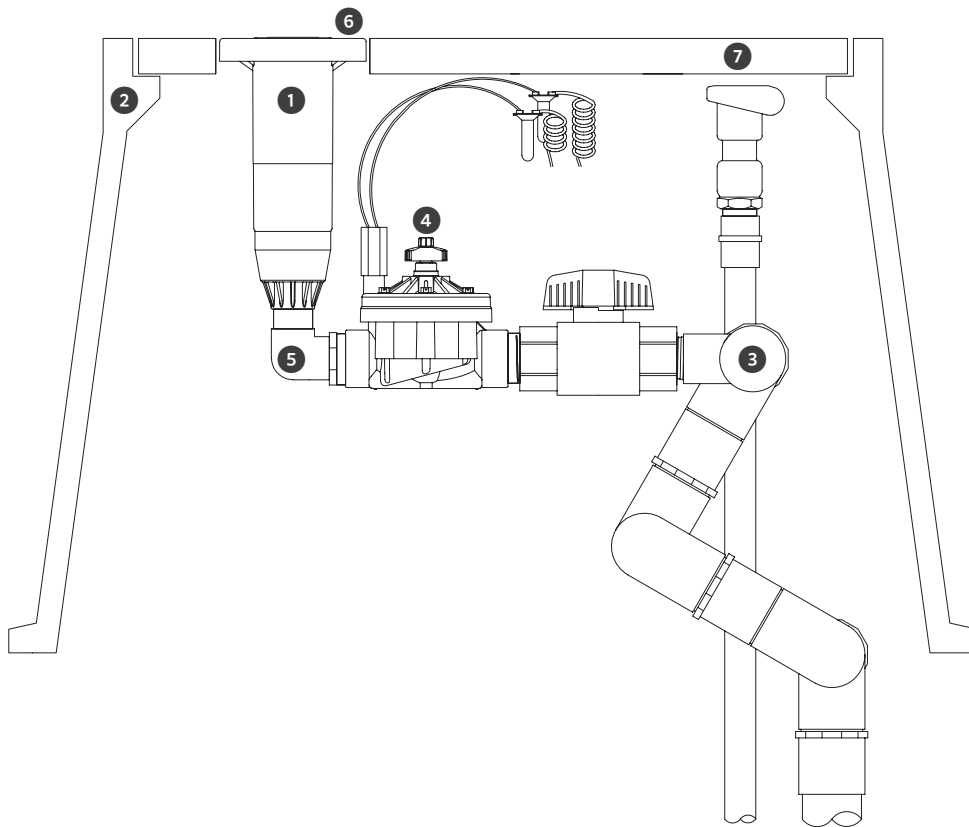

STG-900-KIT-B Components

FIGURE	COMPONENTS TO ORDER	QTY	ITEM DESCRIPTION
1	STG-900-83	1	Pop-up, top serviceable, adjustable arc (40°-360°), 1½" (40 mm) Acme inlet
2	ST-173026-B	1	Composite vault, pre-cast hole for rotor and quick coupler
3	ST-2008-VA	1	Vertical alignment PVC swing joint, seven pivot points, 2" (50 mm) female slip inlet, 1½" (40 mm) female Acme outlet
4	ST-VBVF-K	1	ICV-151G valve, manifold ball valve, 1½" (40 mm) Acme inlet, 1½" (40 mm) Acme outlet
5	239800	1	1½" (40 mm) elbow, female Acme to male Acme, connects STG-900 rotor to ST-VBVF-K
6	473900SP	1	STG-900 rubber cover kit
7	HQ-5RC-BSP	1	Quick coupler, 1" (25 mm) BSP inlet, ¼" (32 mm) outlet for key

HUNTER INDUSTRIES | *Built on Innovation®*
 1940 Diamond Street, San Marcos, CA 92078 USA
hunterindustries.com